

Existing Kitchen/Cafeteria

| Space | net sq. ft. |
|-----------------------------------|------------------|
| Kitchen Area | 765 |
| Pantry | 332 |
| Manager's Office | 50 |
| Cooler / Freezer | 239 |
| Staff Lockers / Restroom | 0 |
| Janitor Closet | 35 |
| Dishwashing/Water Heater Closet | 234 |
| Dining Area | 2,619 |
| Serving | 373 |
| Lobby / Restrooms | 0 |
| Table and Chair Storage | 0 |
| Total Gross Square Footage | 5,181 |
| Seating Capacity | 208 |
| Serving Schedule | 5 Turns |
| Students per serving | 150-180 Students |

EXISTING KITCHEN/CAFETERIA

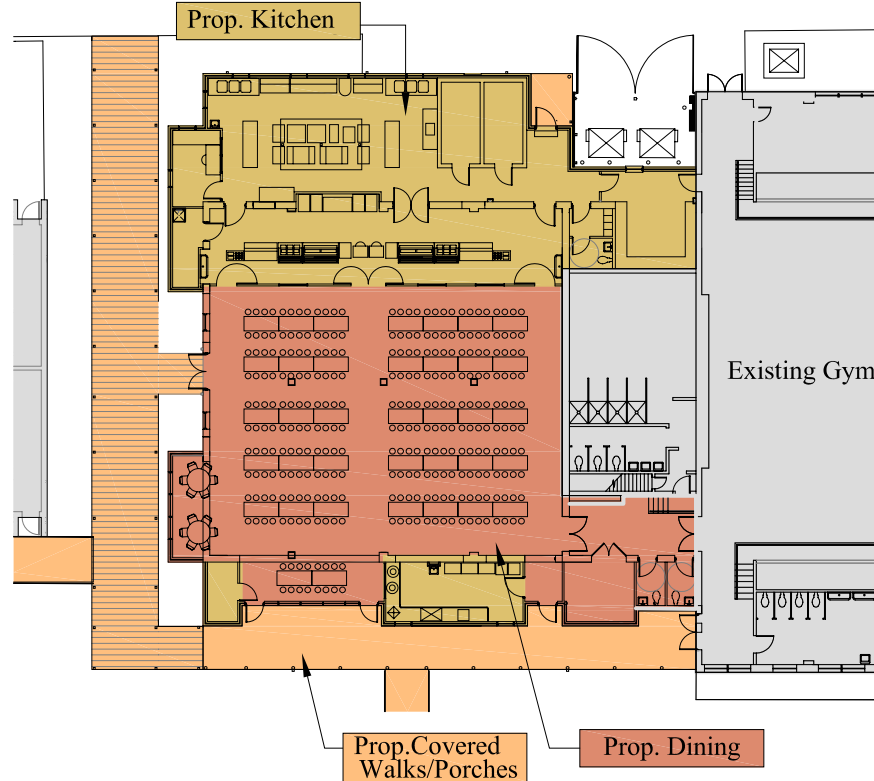

Proposed Kitchen/Cafeteria Additions and Renovations

| Space | net sq. ft. |
|-----------------------------------|------------------|
| Kitchen Area | 997 |
| Pantry | 514 |
| Manager's Office | 106 |
| Cooler / Freezer | 239 |
| Staff Lockers / Restroom | 77 |
| Janitor Closet | 66 |
| Serving | 837 |
| Dining Area | 3,293 |
| Dishwashing/Water Heater Closet | 297 |
| Lobby / Restrooms | 302 |
| Table and Chair Storage | 124 |
| Total Gross Square Footage | 7,400 |
| Seating Capacity | 308 |
| Serving Schedule | 3 Turns |
| Students per serving | 270-292 Students |

PROPOSED KITCHEN/CAFETERIA ADDITION & RENOVATION PLAN